

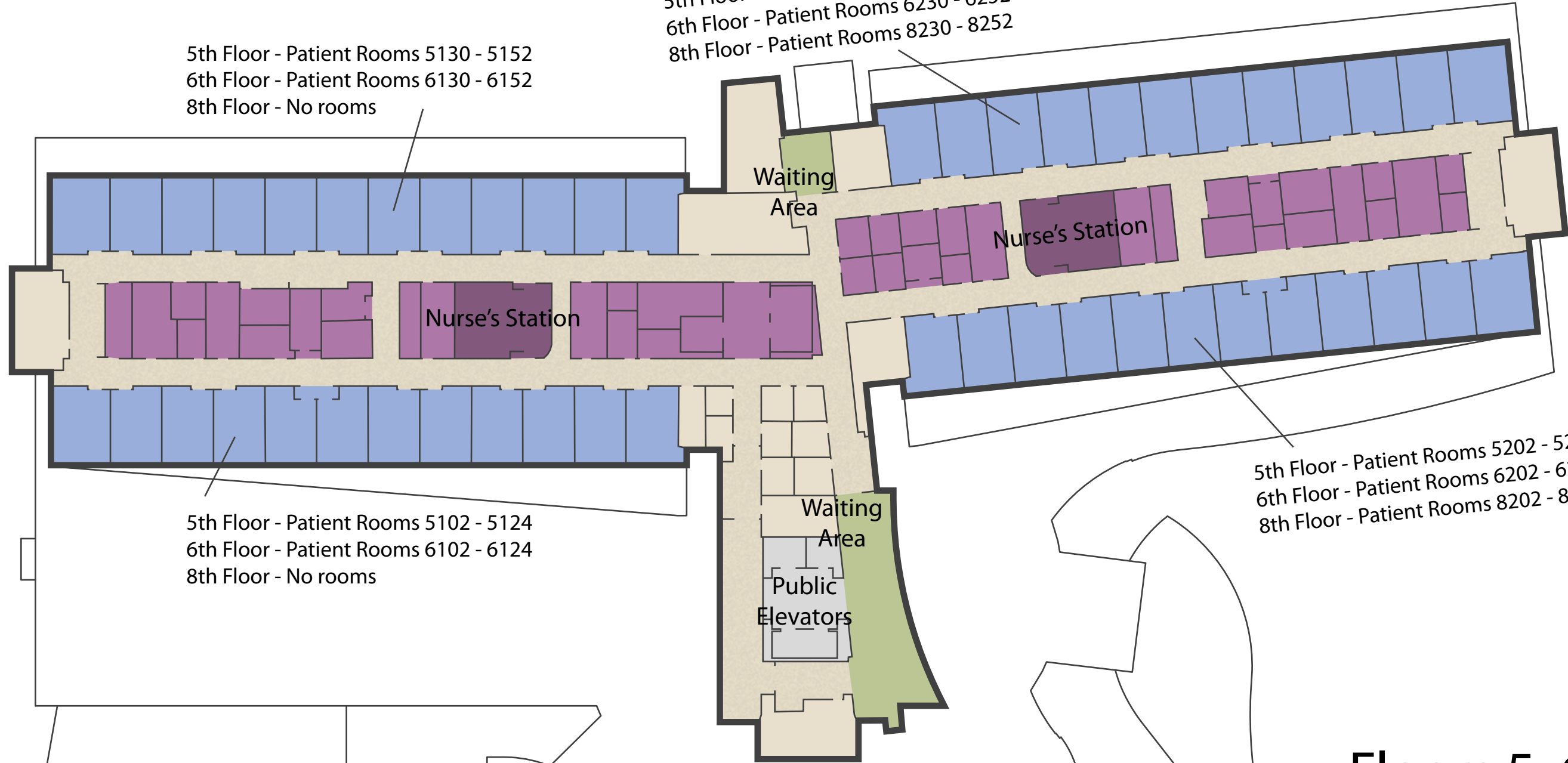

5th Floor - Patient Rooms 5130 - 5152
6th Floor - Patient Rooms 6130 - 6152
8th Floor - No rooms

5th Floor - Patient Rooms 5230 - 5252
6th Floor - Patient Rooms 6230 - 6252
8th Floor - Patient Rooms 8230 - 8252



5th Floor - Patient Rooms 5102 - 5124
6th Floor - Patient Rooms 6102 - 6124
8th Floor - No rooms

5th Floor - Patient Rooms 5202 - 5224
6th Floor - Patient Rooms 6202 - 6224
8th Floor - Patient Rooms 8202 - 8224

Floors 5, 6 & 8

© 2009 Headstand Media

-  Patient Rooms
-  Public Area
-  Staff Area
-  Public Elevators